

UDPP

NEW

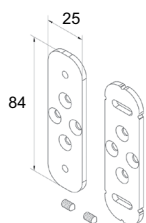

Distance handle for guide channel

Packing: set

UDPP/x • used with PZ UDPP, PW UDPP and guide channels: PP 45, PP 53, PP 68, PP 66, PPDO 53, PPMO 53, PPD 79

x	Colour	
00	mill finish	1
02	white	1
03	grey	1
05	beige	1
08	dark brown	1
09	brown	1
23	anthracite grey	1

PZ UDPP

NEW

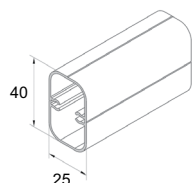

External profile UDPP

Packing: pcs. x m

PZUDPP/x • used with: UDPP, PW UDPP

x	Colour	
00	mill finish	1x3
02	white	1x3
03	grey	1x3
05	beige	1x3
08	dark brown	1x3
09	brown	1x3
23	anthracite grey	1x3

PW UDPP

NEW

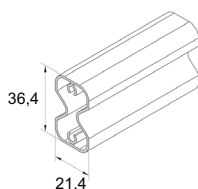

Internal profile UDPP

Packing: pcs. x m

PWUDPP/x • used with: UDPP, PZ UDPP

x	Colour	
00	mill finish	1x3
02	white	1x3
03	grey	1x3
05	beige	1x3
08	dark brown	1x3
09	brown	1x3
23	anthracite grey	1x3

Distance components:

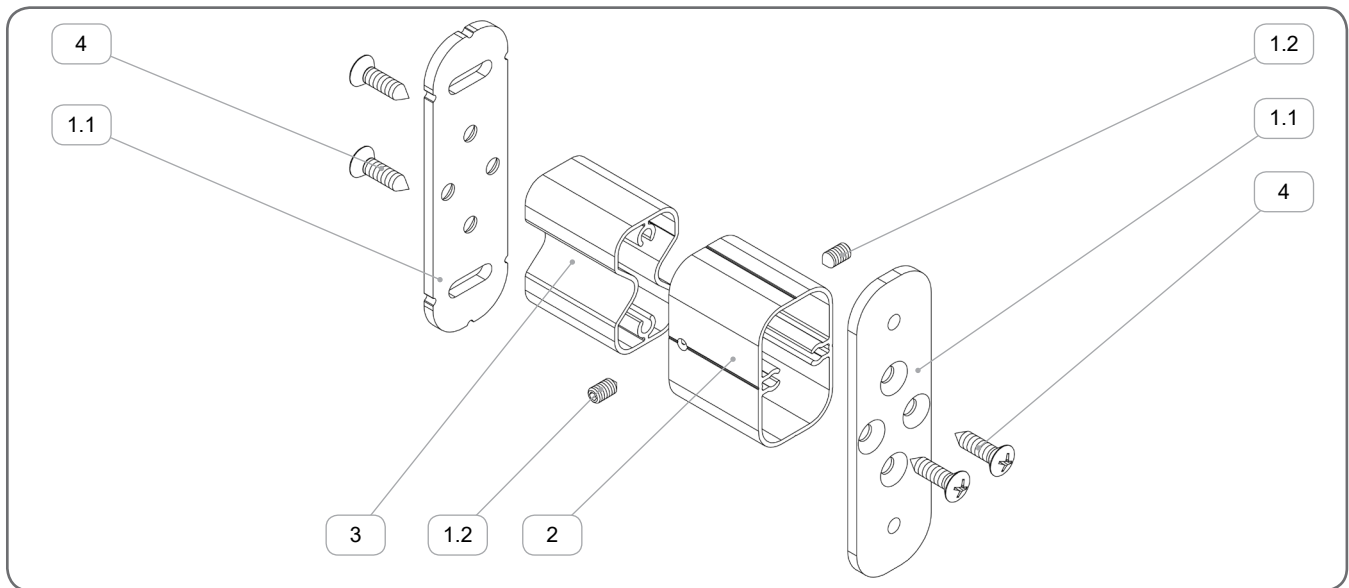

	Name of the component	Catalog code
1.	Distance handle for guide channel	UDPP
1.1	Mounting plate	
1.2	Grub screw	
2.	External profile UDPP	PZ UDPP
3.	Internal profile UDPP	PW UDPP
4.	Galvanized screw 4.2 x 16 mm	WKR/Zn/S/4,2x16

Method of distance installation:

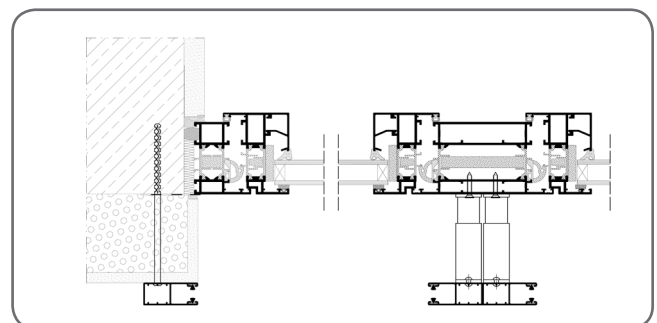
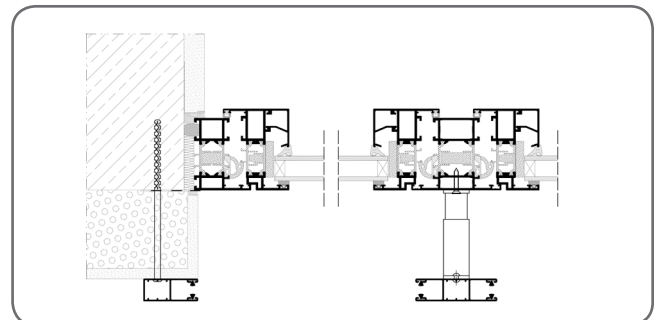
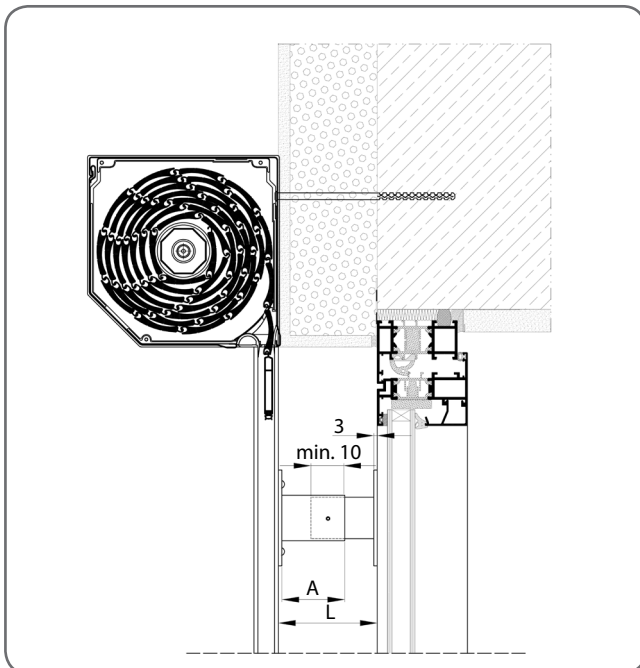

 The length of the distance **L** can not be less than 30 mm.

Stages of distance installation:

Firstly, determine the dimension **L**, then trim the outer and inner profiles to the length **A**, which should be determined in accordance with the guidelines:

L ≥ 50 mm A = 3/4L

L < 50 mm A = 2/3L

Fasten the cut profiles with the handle flat bars according to the diagram as in the drawings:

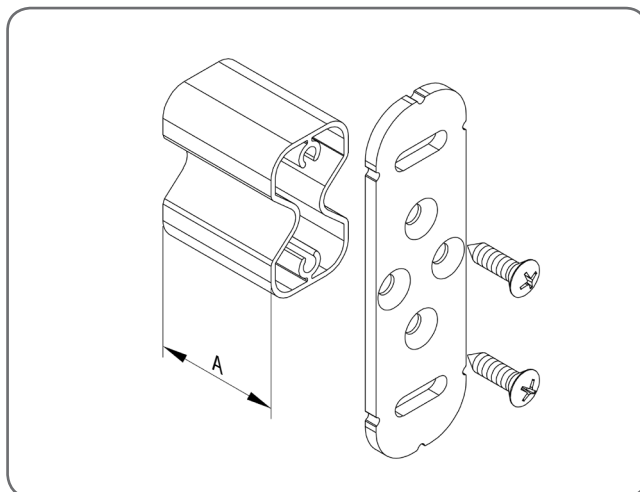
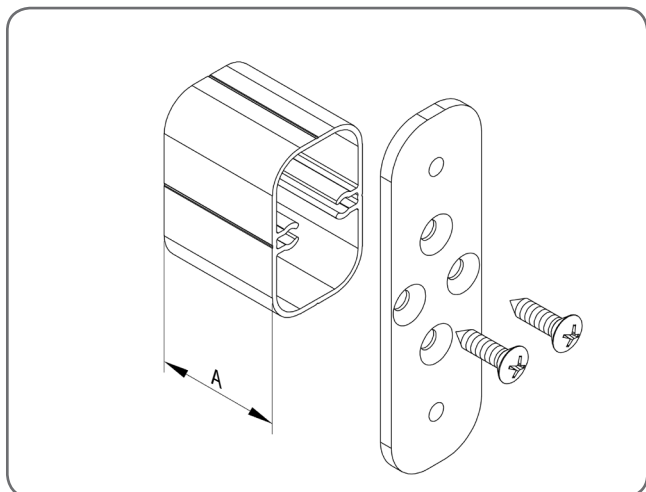

Match the fastened parts of the distance to the width **L** and determine the centre.

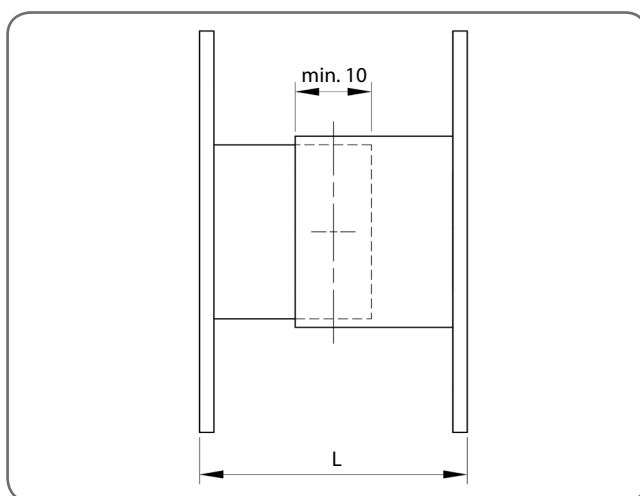
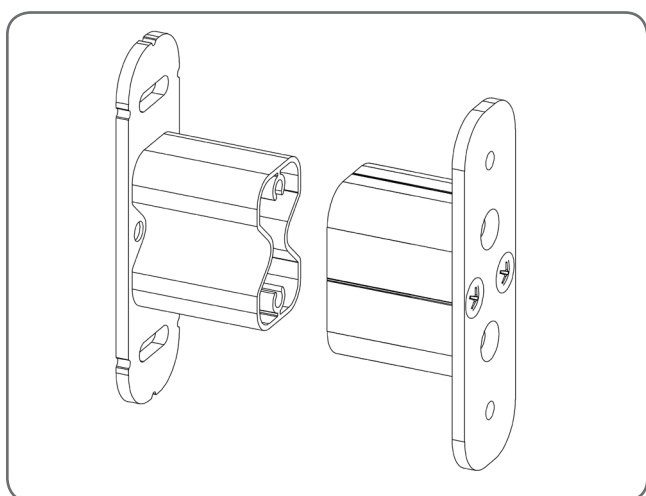

At the point where the center is defined drill a through hole $\varnothing 3,5$ mm, then slightly screw the grub screws from the set.

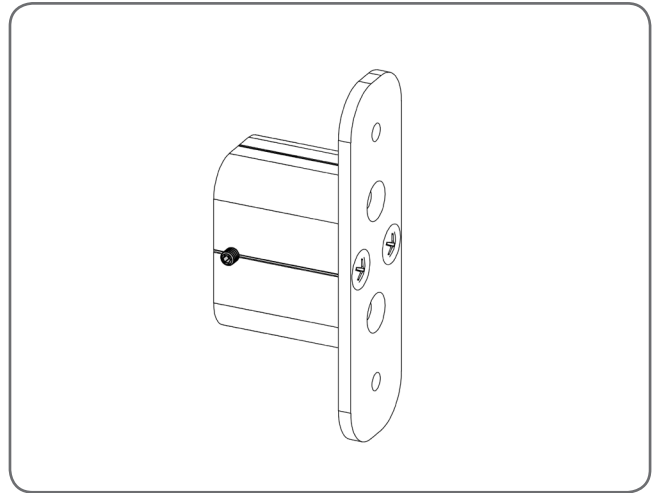
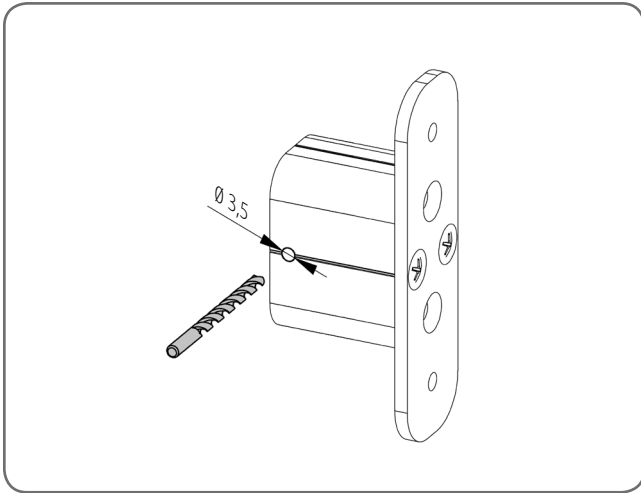

Measure 150 mm from the distance axis to the edge of the guide channel, mark the place for one of the holes. Then drill the hole $\varnothing 4,1$ mm using the template **SOP 2**.

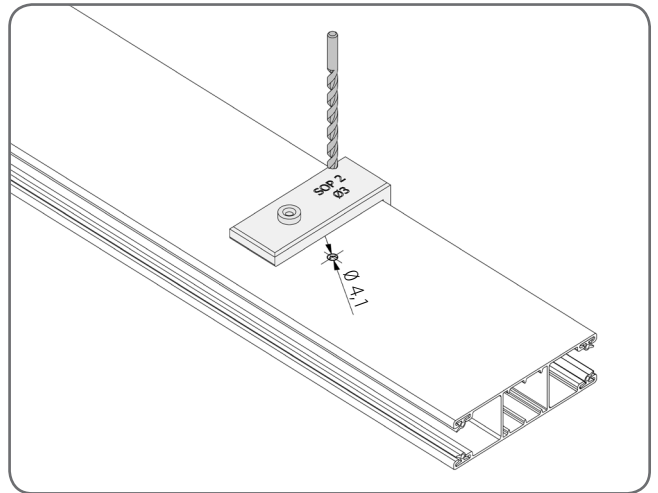
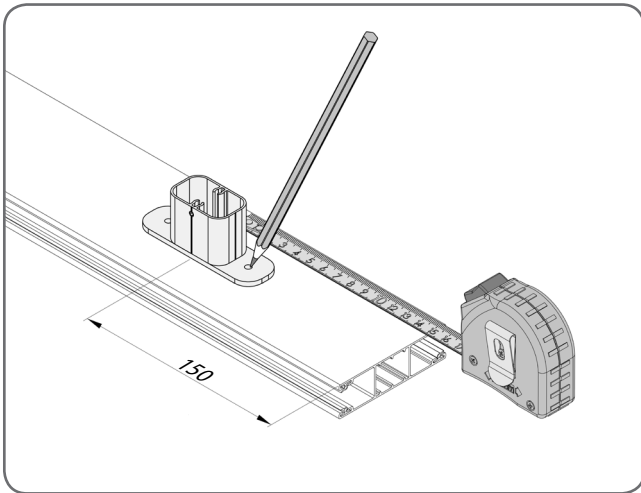

Determine along the guide channel axis the outer part of the distance and rivet. Drill the second hole directly through the distance and also rivet.

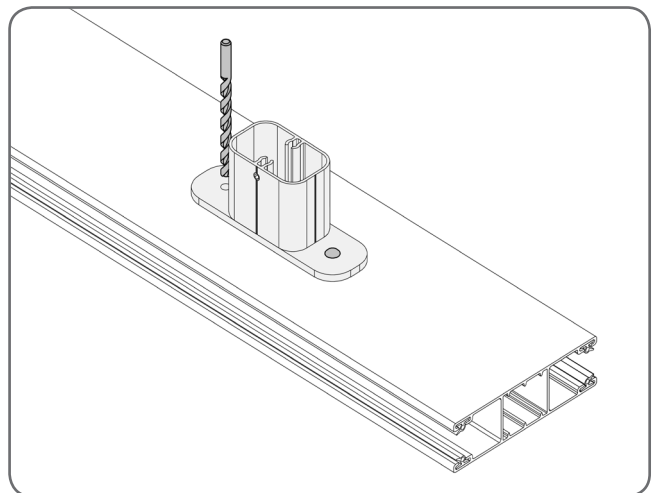
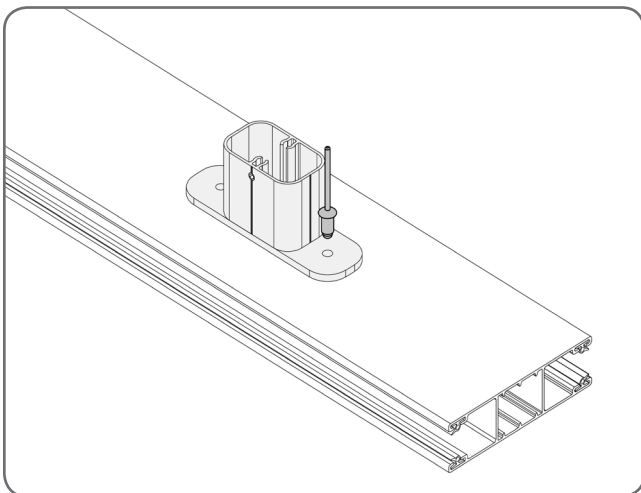

Fix the extreme distances at a distance of 150 mm for the edge of the guide channel, each next distance at a distance of no more than 750 mm.

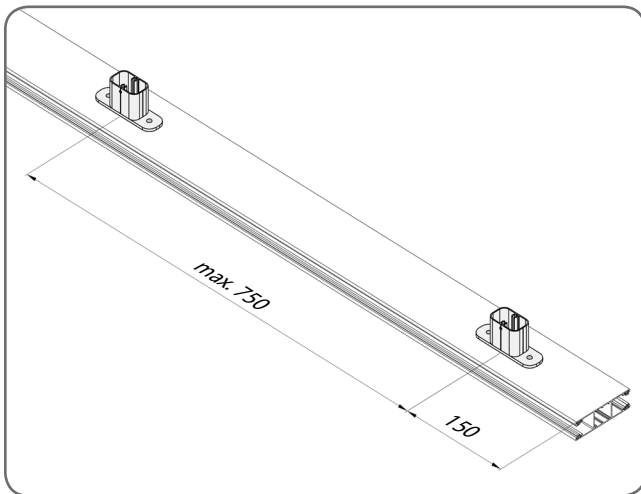

Fold the distance and with the entire roller shutter place at the target mounting position, align the guide channels and mark the drilling positions. For this purpose use the marks in the flat bar with longitudinal holes as in the diagrams below.

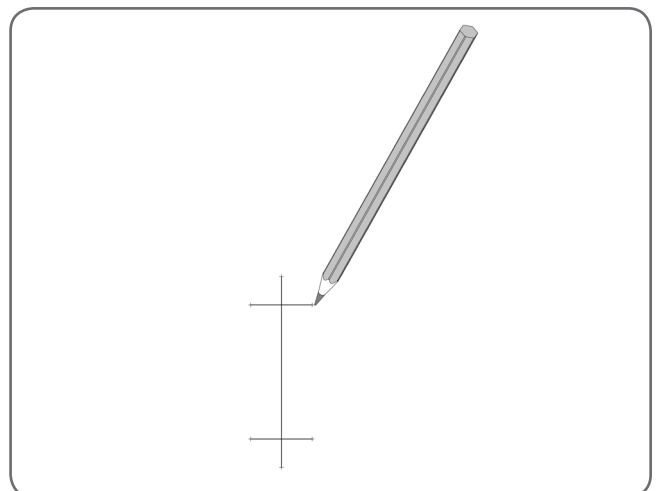
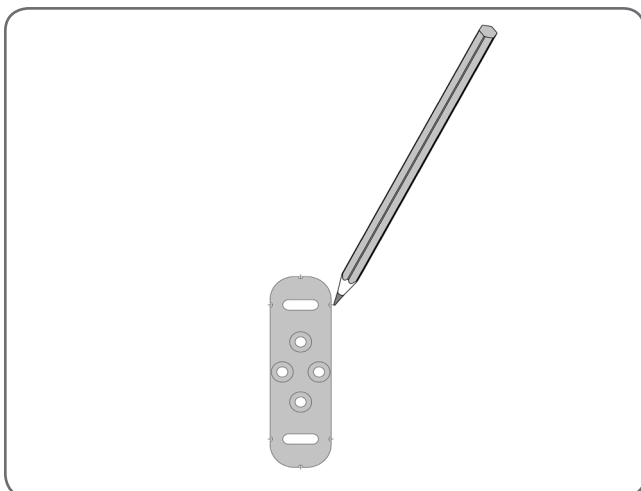
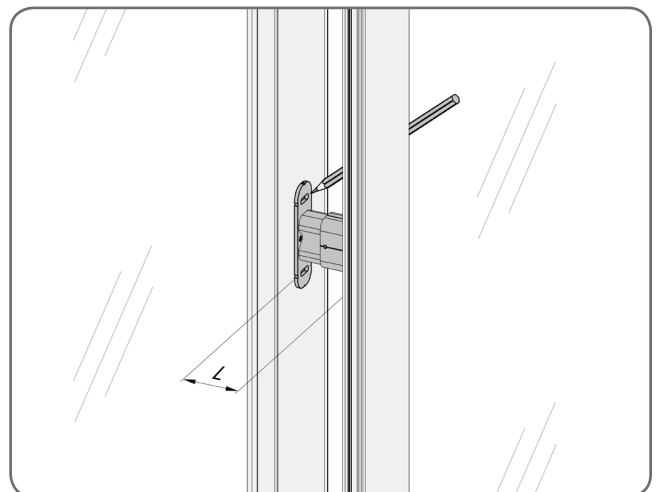
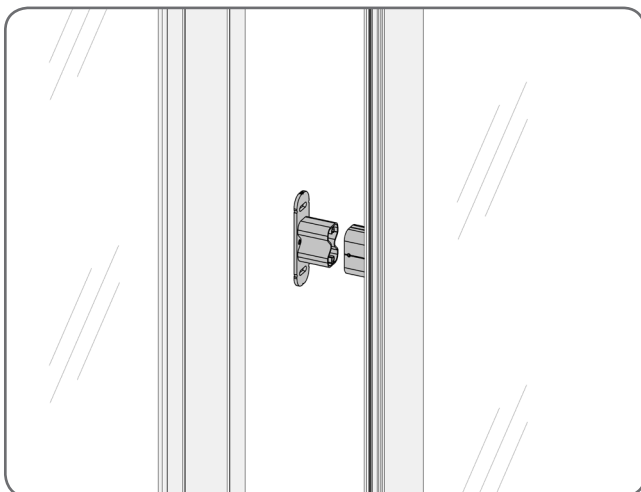

Depending on the type of the surface, to which the distance is to be installed and the type of used screws, drill the appropriate holes.

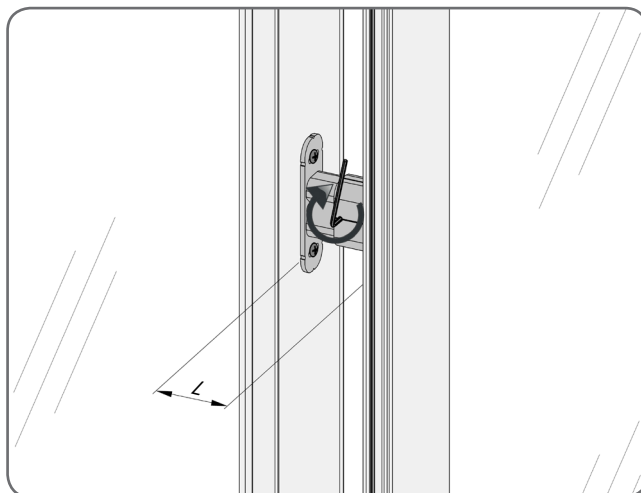
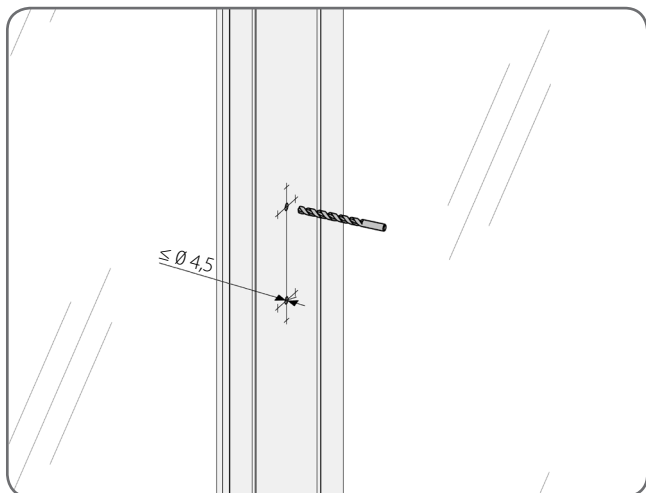

 The maximum diameter of the holes for fixing the distance can not exceed $\varnothing 4,5$ mm.

Additional way to stabilize the installation of the distance:

It is possible to further stiffen the distance by riveting or fastening both profiles.

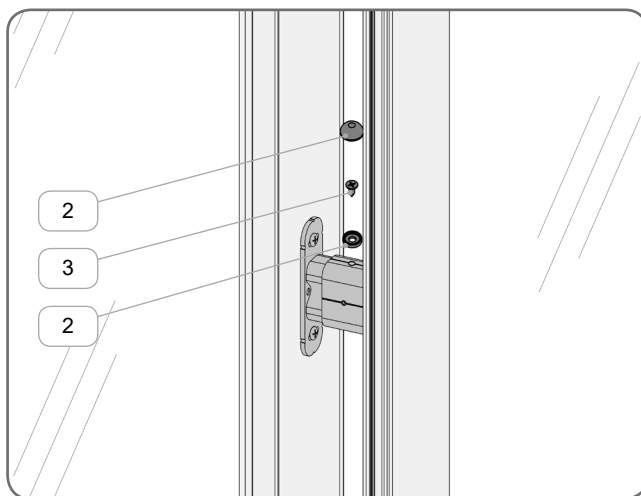
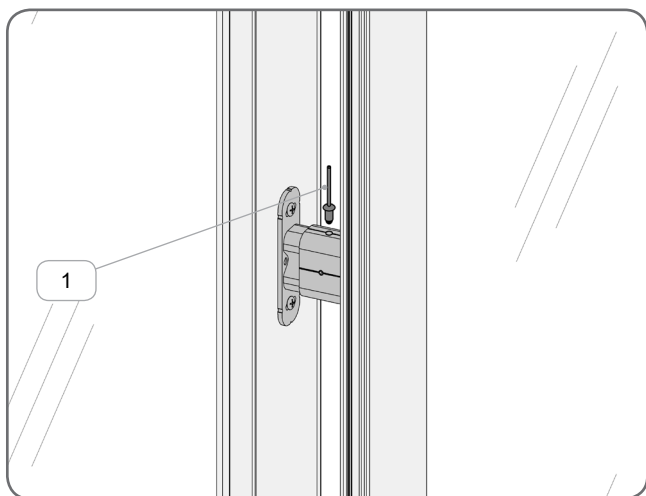

	Name of the component	Catalogue code
1.	Aluminum rivet	PN 4 x 8
2.	PVC cap with cover	ZPK 10
3.	Screw	WKR/Zn/W/3,9x9,5 WKR/A2/W/3,9x9,5 WKR/Zn/W/3,5x9,5

 Rivets or screws can be mounted from the top or bottom of the distance.